

# CONNECTOR N-Female

# N-KFB2G

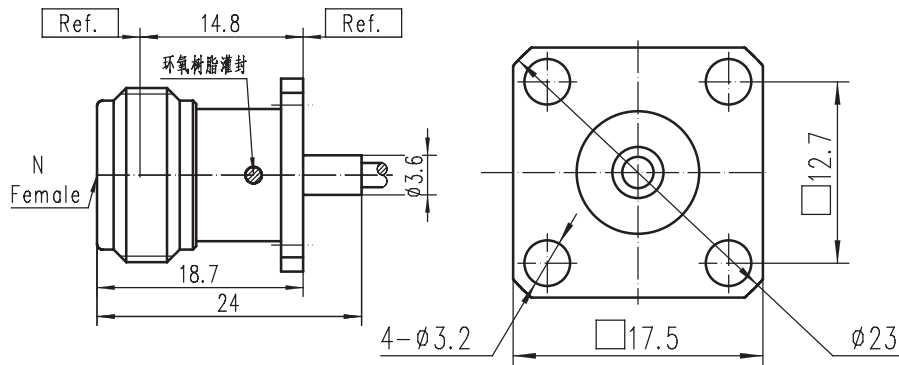

Code: 200024

## Electrical data

Impedance	50 $\Omega$
Frequency	DC to 11 GHz
Return loss	$\geq 30$ dB, DC to 2.5 GHz $\geq 26$ dB, 2.5 to 4 GHz $\geq 20$ dB, 4 to 5 GHz
Insertion loss	$\leq 0.05$ dB, DC to 5 GHz
Insulation resistance	$\geq 5 \times 10^3$ M $\Omega$
Center contact resistance	$\leq 1$ m $\Omega$
Outer contact resistance	$\leq 0.25$ m $\Omega$
Test voltage	2500 V rms
Working voltage	1400 V rms

## Mechanical data

Mating cycles	min. 500
Center contact captivation: axial	$\geq 28$ N
radial	$\geq 3$ Ncm
Coupling test torque	max. 1.7 Nm
Recommended torque	0.7 Nm to 1.1 Nm

## Material and plating

Connector parts	Material	Plating
Center contact	CuBe	Gold
Outer contact	Brass	Gold
Body	Brass	Gold
Dielectric	PTFE	

## Environmental data

Temperature range	-65°C to +165°C
Thermal shock	MIL-STD-202, Meth. 107, Cond. B
Corrosion	MIL-STD-202, Meth. 101, Cond. B
Vibration	MIL-STD-202, Meth. 204, Cond. B
Shock	MIL-STD-202, Meth. 213, Cond. I
Moisture resistance	MIL-STD-202, Meth. 106
2002/95/EC (RoHS)	compliant

Shanghai Tuyue electronics Co. Ltd.

Tel.: +86 21 64753655 Fax: +86 21 61257270  
Email: info@tuyue.com.cn Website: www.tuyue.com.cn