

2.92mm - 2.4mm Between Series Adaptor

Main Specification		Material/Finishes	
Impeadance	50Ω	Body	SUS303 / Passivated
Frequency	DC ~ 40GHz	Inner Contact	CuBe / Gold Plated
Durability	≥500 Cycles	Isulator	PEI
Operating Temp.	-60°C ~ +165°C		

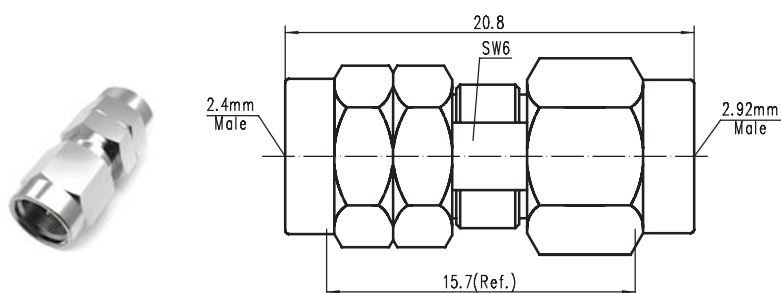

CODE: 100016

TYPE: 2.92mm / 2.4mm - JJG

VSWR: DC - 40GHz...1.15 : 1(max)

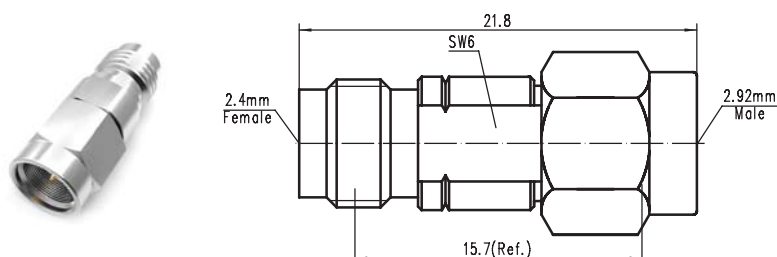

CODE: 100017

TYPE: 2.92mm / 2.4mm - JKG

VSWR: DC - 40GHz...1.15 : 1(max)

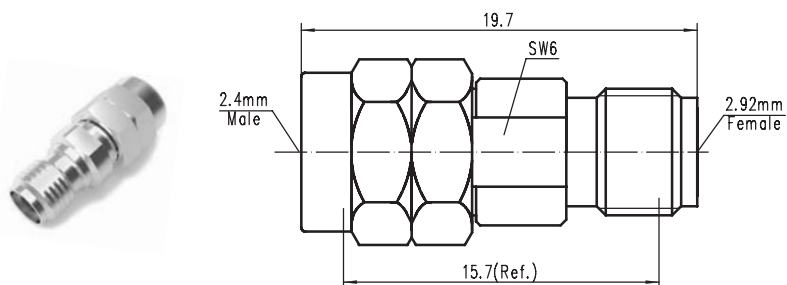

CODE: 100018

TYPE: 2.92mm / 2.4mm - KJG

VSWR: DC - 40GHz...1.15 : 1(max)

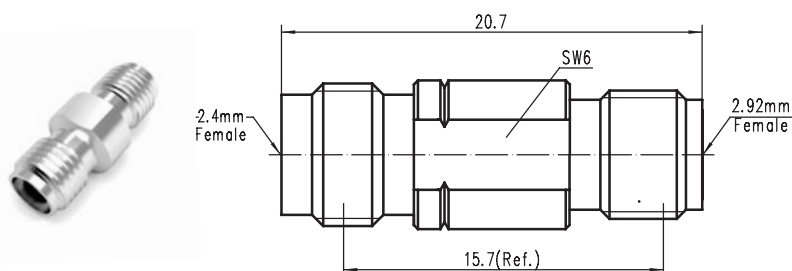

CODE: 100019

TYPE: 2.92mm / 2.4mm - KKG

VSWR: DC - 40GHz...1.20 : 1(max)