

2. 92mm – SMA系列间转接器

主要性能指标		材料/表面处理	
特性阻抗	50Ω	壳体	不锈钢SU303 钝化
频率范围	DC ~ 27GHz	内导体	镀铜 镀金
连接器耐久性	≥500次	绝缘体	PEI
温度范围	-60°C ~ +165°C		

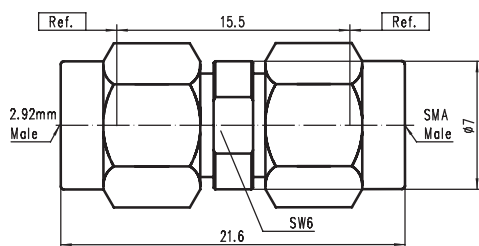

CODE: 100088

TYPE: 2.92mm / SMA - JJG

VSWR: DC - 27GHz...1.15 : 1(max)

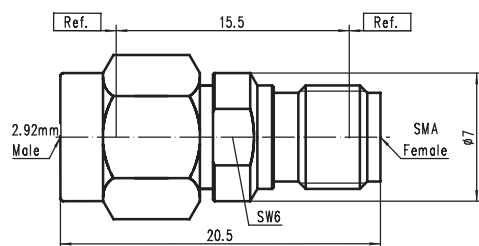

CODE: 100089

TYPE: 2.92mm / SMA - JKG

VSWR: DC - 27GHz...1.15 : 1(max)

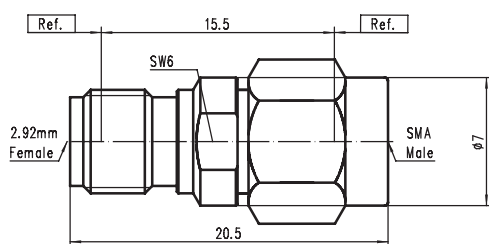

CODE: 100090

TYPE: 2.92mm / SMA - KJG

VSWR: DC - 27GHz...1.15 : 1(max)

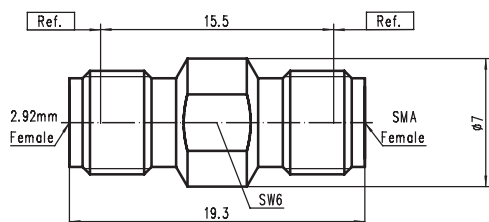

CODE: 100091

TYPE: 2.92mm / SMA - KKG

VSWR: DC - 27GHz...1.15 : 1(max)